



HOLZKLUSIV
Wellness für Zuhause

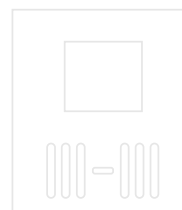



Table of Contents



Introduction	5	Preparation of the installation site	26
Hot Tub SAPHIR with integrated wood stove	6-7	Use / Maintenance	27
Hot Tub JADE with external wood stove	8-9	Heat water correctly	28
Hot Tub OPAL with external wood stove	10-11	Water cleaning / care	30-31
Scope of supply / accessories	12-13	Technical information	32-35
Advantages	14-15	Positioning switches / filters	36
Exterior cladding	16-17	What do I have to consider?	37
Colours and covers	18-19	Buy a hot tub	38-41
SPA Wellness system	20-25	Production in Gummersbach	42-43



*"We make your home
something special!"*



HOT TUB = BATHING BARREL

A special kind of whirlpool for a pleasant bathing environment

Originally the hot tubs come from the Scandinavian countries. Many natural hot water springs which offer people relaxation and recovery are found there. Modelled on these springs, the first outdoor bathing tubs heated with fire were created centuries ago. Over the years, the classic bathing tubs / bathing barrels have developed into real functional outdoor whirlpools with lots of comfort, massage jets and ambient lighting.

With our premium hot tub models and barrel saunas you will experience your home in a new way. Configure your bath barrel conveniently online, by phone or visit our showroom in Gummersbach. Choose your bathtub colour, size, SPA system, cover, lighting, wood type, accessories, and much more. In combination with our barrel saunas in different sizes and types of wood, you can turn your garden into a wellness oasis that you can use regardless of the seasons.



Hot Tub SAPHIR



Hot Tub JADE



Hot Tub OPAL

*"Space-saving
everything in one
bath barrel!"*



The stylishly compact and most popular

Hot Tub SAPHIR with integrated wood stove

180 cm*
4-6 Persons

200 cm*
6-8 Persons

Completely pre-assembled and ready to use for your first wellness session:
Our hot tub with integrated wood-burning stove.

The elegant compact design enables space-saving assembly and offers the advantage that the heat is thereby transferred directly to the water. Adding wood while sitting in the hot tub - no problem!

An additional natural heat circulation is created via integrated pipes located on the inside. The heating time for an optimal bathing temperature of 37- 40°C is about 2-3 hours, depending on the amount of water, the outside temperature and the operation of the stove.

The recess for the stove is popular as a booster seat for children or to cool down, and also serves as an armrest for a more stable seat.



* inside diameter

Wellness for home





*"Even more space
in the tub!"*

The classic

Hot Tub JADE with external wood stove

180 cm*
6-8 Persons

200 cm*
8-10 Persons

You would like to have even more space in the hot tub?

You have enough space in your garden to place your new hot tub in a spacious way?

Would you like to integrate / recess your hot tub into a patio or slope?

Then this model is the right option for you!

The full-length tub offers equally ergonomic seating, for up to 8 people, as the niche for the stove is eliminated.



* inside diameter

Wellness for home





*"For that special
romance!"*

Cosy tub shape for 2 people

Hot Tub OPAL with external wood stove

Length
170 cm*
2 Pers.

Whether alone or as a couple. The eye-catcher for every garden or terrace.

With the shape of a classic bathtub, this hot tub is a highlight.

Thanks to its oval shape, the ergonomically shaped tub hugs your body and, in combination with the cosy warmth and massage function, gives you the ultimate feeling of well-being and relaxation.

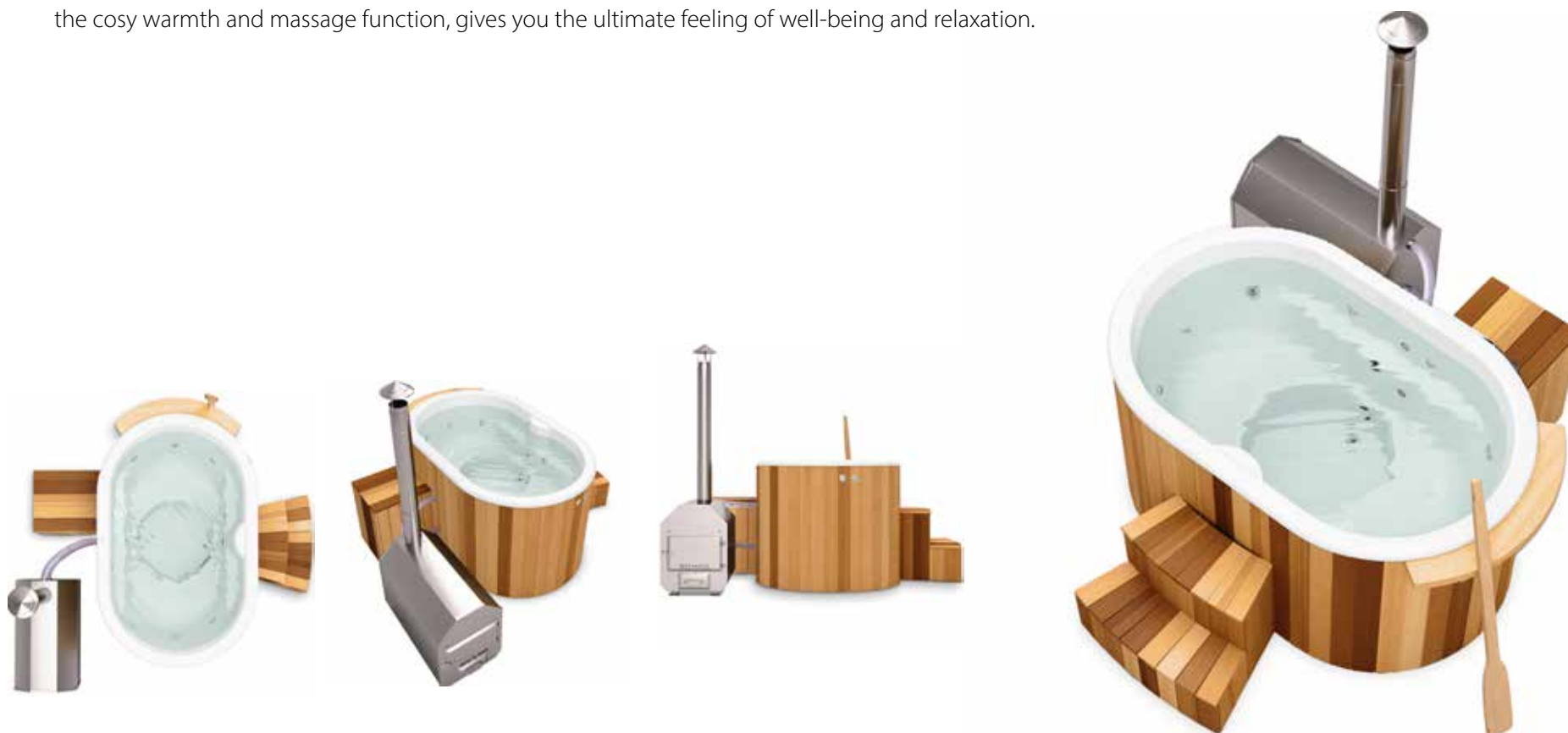

* inside diameter

Wellness for home



Scope of supply

Included with your hot tub are:



Stainless steel heater 316V 4A suitable for chlorine and salt water



2 m stainless steel chimney with rain protection cap



Rounded wooden staircase to match your hot tub



Drinks shelf



Ball valve for water supply / drainage

Save with the pre-configured hot tub packages in the online shop



Making your hot tub even better



SPA system *KOLLER* WHIRL-SYSTEMS
with control unit



Multicolor LEDs



Thermal cover



Decorative rings



Sand filter box
to match your hot tub



Filter system



Our hot tubs are special

Integrated or external wood-burning stove in V4A stainless steel

Your Holzklusiv Hot Tub is suitable for use with both chlorinated and salt water as standard. The heater, inlets and nozzles are also made of high-quality V4A stainless steel for maximum protection against corrosion.

The integrated wood stove has the additional advantage that it gives off heat directly to the water.



Ergonomic premium glass fibre tub (GRP)

The tubs are ergonomically shaped and adapt to your body so that you feel permanently comfortable when sitting down. You can configure different massage zones as you wish. The jets are positioned in such a way that, as with a classic massage, only the muscles are massaged and not the spine itself. The GRP tubs are finished in a special process. The surface is therefore optimally protected against UV light and offers a pleasant feeling when in contact with the skin.

Available in many different versions

We offer 3 models in different sizes, with internal as well as external stoves. Choose the right material for your exterior cladding from one of 3 types of wood. In addition, we offer a variety of different paints for the spruce wood version. In addition to different lid shapes and tub colours, the SPA system is also available in different configurations and can be adapted to your personal requirements.





Insulation cover for long-lasting warm water

A premium leather thermal cover protects your hot tub from dirt and precipitation. But it also has an insulating effect: The water is heated up up to 25 % faster (in combination with a tub insulation) and cools down much slower, so that the heating time the next day is significantly reduced. But you can also choose a wooden or plastic lid as a less expensive alternative.

TÜV approved water & air nozzles

You can choose between an air bubble system or a powerful water pressure massage. Or you can opt for a combination of both (independently controllable). We consistently focus on quality and do not use suppliers from Asia. All our pumps, blowers, nozzles, electronic components, the control and the connection technology come 100% from the Koller factories in the EU. TÜV tested and CE certified – only available at HOLZKLUSIV.



Wide range of accessories

In addition to add-on parts such as stairs, filter boxes, sand filters, UV lamps, skimmers, exhaust pipe extensions or drinks shelf, you will find all the necessary accessories and care products with which you can operate and care for your hot tub.

Exterior cladding

3 basic wood types

The exterior cladding is made of solid wood and you can choose between 3 different types of wood. Spruce is the least expensive wood and red cedar is the most expensive. Spruce wood can be additionally painted with your desired colour. Each type of wood must be treated with colourless oil several times a year so that it lasts longer. In addition, spruce wood can still be painted with a wood paint.



Spruce

Due to its positive swelling and shrinkage behaviour, spruce wood is the all-rounder for the construction of wooden objects for the garden. Unbeatable in price / performance ratio, it shows a low tendency to crack and deform. We offer our hot tubs made of spruce wood in different paints for an optimally adapted appearance.

Since spruce naturally stores a particularly large amount of water, it is the wood that requires the most intensive care.

(See Page 21).



Thermo-wood

Compared to untreated wood, this type of wood has certain advantages in terms of dimensional stability, hardness, rot protection and the reduction of cracking. Thermally modified wood is the end product of a process for treating solid wood, which is made particularly durable by means of steam, heat and drying.

It is easier to maintain and has a longer life than spruce.



Red Cedar

The red cedar wood offers a particularly noble appearance due to the differently colored wood lath. This type of wood grows in damp, cold areas and already has similar properties to thermowood in its untreated state. With a durability class of 2, red cedar will last for a long time with sufficient care. By choosing this cladding, you also contribute to environmental protection, as the wood does not need to be impregnated with chemicals.



Types of wood and different coatings



Spruce



Thermowood



Red cedar

NATURAL



Spruce white



Spruce Oak light



Spruce Oak rustic



Spruce pine



Spruce silver grey



Spruce salt green



Spruce fir green



Spruce stone pine



Spruce Hemlock



Spruce Mahagoni



Spruce Teak



Spruce nut



Spruce rosewood



Spruce chestnut



Spruce ebony

PAINTED

*The illustrations show the possible colour variations using the example of the hot tub model with integrated stove and a tub inside diameter of 180 cm and apply to hot tubs with both integrated and external stoves with diameters of 180 and 200 cm and 170 cm oval.

Different cover versions and finishes



Lids in
3 sizes and
Shapes available



**Thermolid
black**

For SAPHIR, JADE and OPAL



**Thermolid
red-brown**

For SAPHIR, JADE and OPAL



Tub SAPHIR, 180 cm*, internal wood stove



Tub SAPHIR, 200 cm*, internal wood stove



Tub JADE, 180 cm*, external wood stove



Tub JADE, 200 cm*, external wood stove



Tub OPAL, 170 x 100 cm*, external wood stove

* inside diameter

Wellness for home



SPA SYSTEM

*Wellness for
body and soul*

SPA system for your personal wellness experience

Powerful water / air jets and LED lighting

Where water and electricity meet, we leave nothing to chance. All our pumps, blowers, nozzles, electronic components, the control and the connection technology come 100% from the Koller factories in the EU. TÜV tested and CE certified – only available at HOLZKLUSIV.



The air jets give your hot tub the typical „bubbling“ effect and the benefits of a whirlpool.



Water jets force the heated water into the pool under pressure and provide a pleasant spot massage.



KOLLER WHIRL-SYSTEMS



The 3 integrated LED lights provide the right ambience in any environment.

With our combined water massage system, the combination of air and water jets provides an even stronger massage effect.

Wellness for home



SPA facility for your personal wellness experience

Possible combinations of water / air nozzles in hot tubs with integrated stoves

Tub with LED lighting

3 LED lamps with colour change function



The illustrations show a tank inside diameter of 180 cm.
For a tank inside diameter of 200 cm, the nozzle distances increase proportionally.

Water massage, 6 nozzles

6 nozzles for SPA water massage, 800 W air blower

3 LED lamps with colour change function (optional)

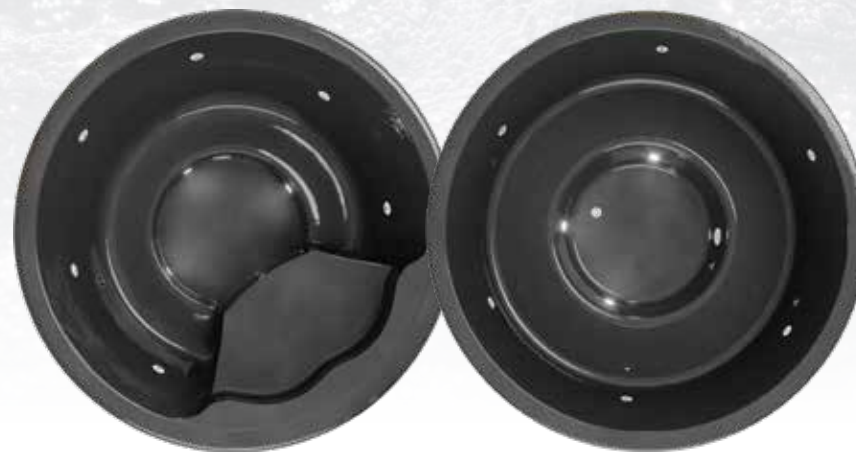



Air massage, 12 nozzles

12 nozzles for SPA air massage, 800 W air blower
3 LED lamps with colour change function (optional)

Hydro-water/air combination, 18 nozzles

6 nozzles for SPA water massage,
1,5 kW water pump
12 nozzles for SPA air massage,
800 W air blower
3 LED lamps with colour change function (optional)



NEW NOZZLE ARRANGEMENT

Something for everyone!



The illustrations show a tank inside diameter of 180 cm.
For a tank inside diameter of 200 cm, the nozzle distances increase proportionally.

www.holzknecht.de



What arrangement of the water nozzles?

The alternative to the classic arrangement

New: The modern nozzle variant

In the classic arrangement, each seat receives its own water massage nozzle. However, often not all participants equally desire a massage. In addition, some wish for a more intense, even more effective, relaxation.

For this reason, together with Koller Spa Systems and physiotherapists, we have developed a modern arrangement of the jets as an additional variant.

The jets are bundled in such a way that massage places and non-massage places alternate. Each massage place offers 3 air jets in the area of the lumbar vertebrae and 2 massage jets, which intensively massage the muscles to the left and right of the spine. At the same time, the spine itself is left out and thus spared.



By changing your sitting position which region of your back is to be massaged. of your back should be massaged.

- Water massage
- Air massage



Preparation of the installation site

It is important that your hot tub is placed on a firm and even surface. The smoke should be able to escape easily and the flue pipe should not be in the direct vicinity of a neighbouring house. If you have any questions, you can also contact your local chimney sweep. A well-compacted lawn is also suitable, but gravel or crushed stone should be preferred as a foundation.

The place where the hot tub is located must not have a slope, unlike a typical terrace structure, so that the water in the hot tub is level. In this case, the installation surface must be levelled.

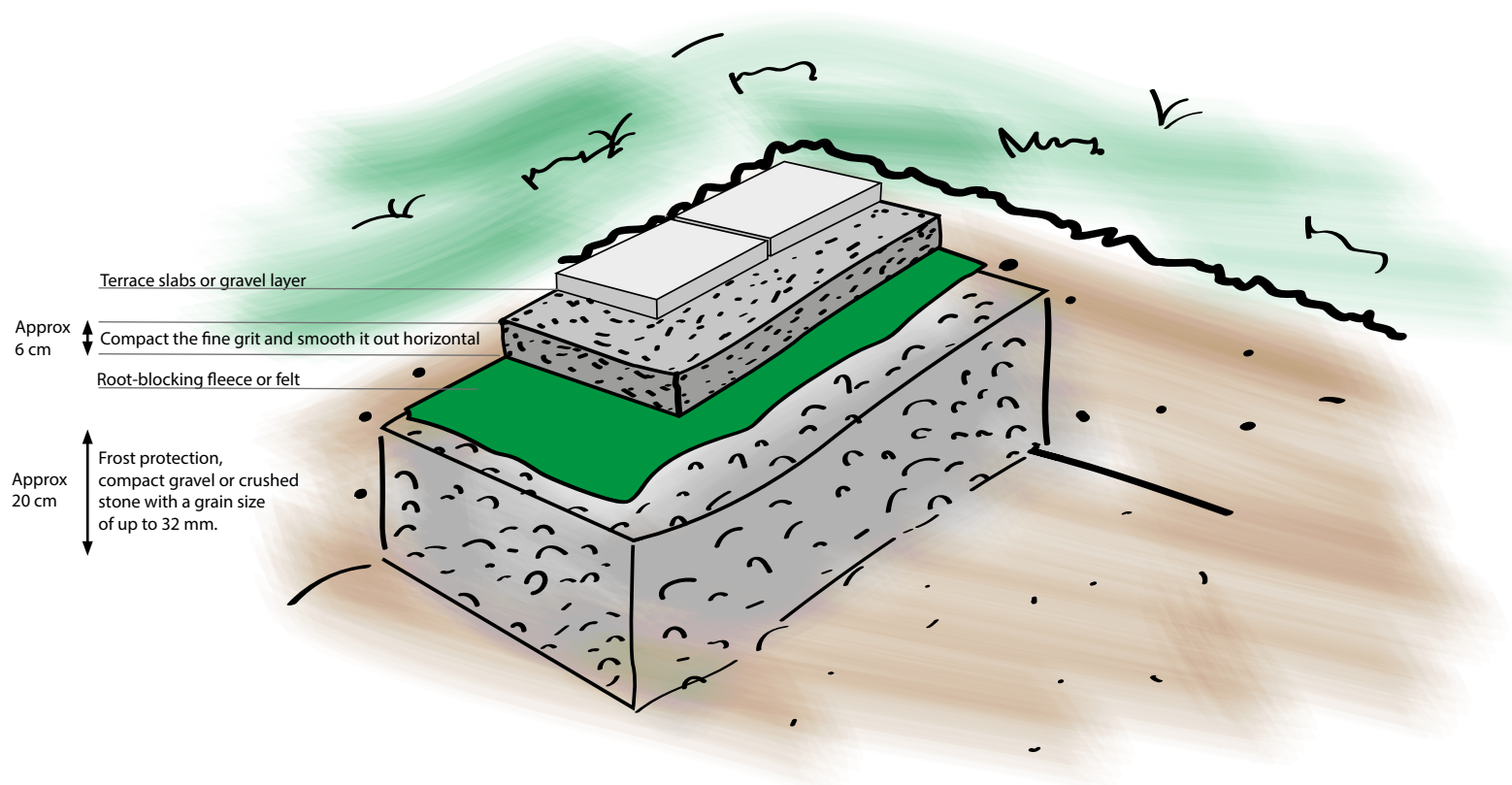

Use and maintenance

Of course, your hot tub also needs a certain amount of care and cleaning to ensure a long service life. These should therefore by no means be dispensed with. The basic rule for use is: shower before each use! Skin creams, oils or hair products lower the quality of the water, which accordingly must be changed more often. Other factors such as the frequency of use, the regular number of people and which additional filters and pumps you use play an important role in cleaning and maintenance.

Empty and clean the stove

To keep your wood-burning stove in optimal condition, you should empty your stove after each use of the hot tub. In doing so, first wait until the stove has cooled down completely and then empty the ash pan or remove the remains with a small ash shovel. Cleaning with a damp cloth afterwards is recommended.

Prepare for the winter

After each use of the hot tub, insert the enclosed winter plugs into the openings below the water line for the supply and return of the wood stove. Then open the ball valve next to the furnace door and wait until the remaining water has been completely drained from the furnace line. This prevents freezing residual water from damaging the wood stove and pipes. Basically, the condition of the filled hot tub should be checked at regular intervals at outdoor temperatures (water temperature, ice deposits, etc.) to prevent permanent damage.

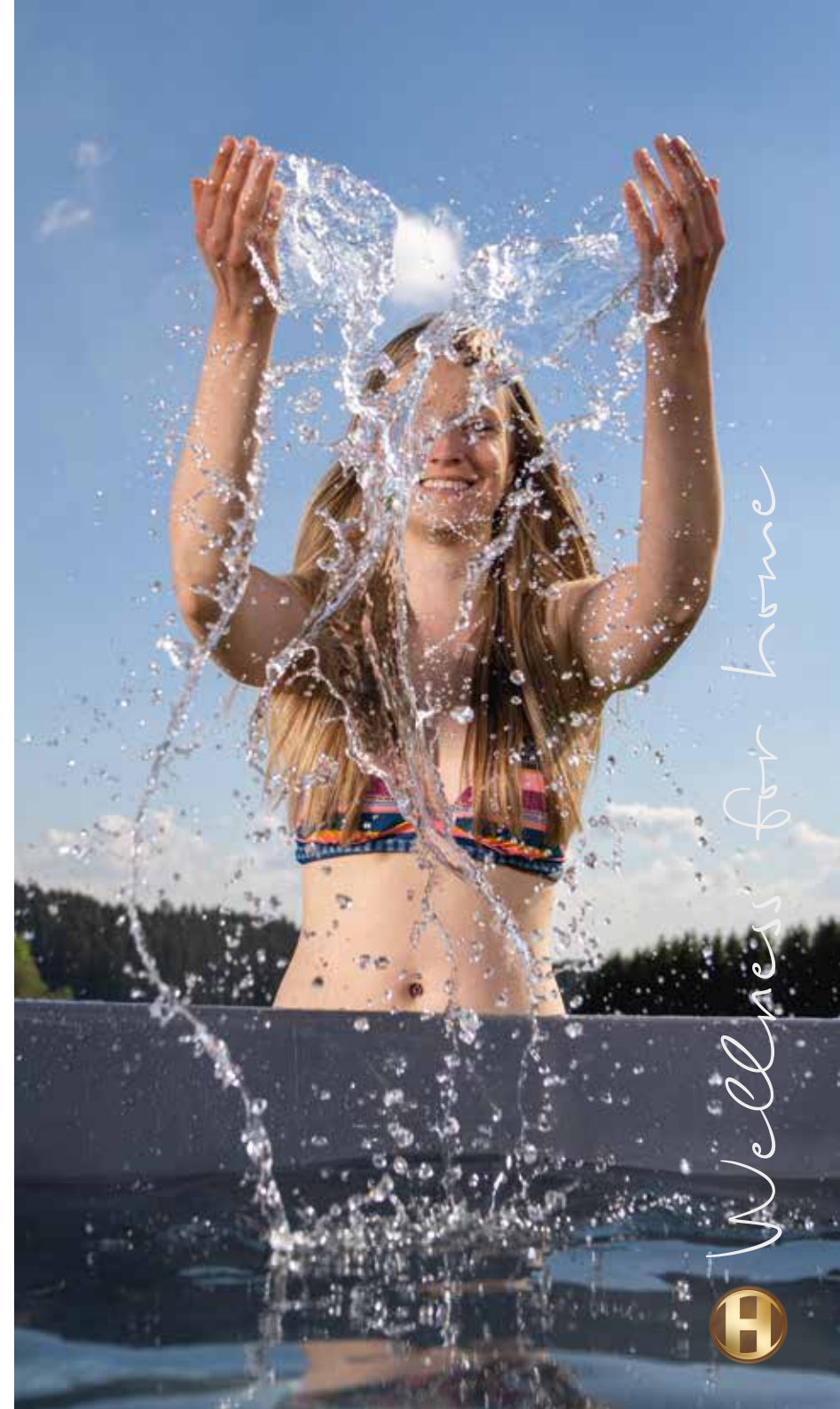

Heat up the water properly

A warm hot tub in winter not only provides warmth in the cold season, but also puts your muscles and your entire body in a relaxed state. Whether with family or friends, a hot tub leaves nothing to be desired. Of course, there are hot tubs that are heated with electricity, but where is the fun in that? Our hot tubs are fired with wood and are a real eye-catcher in your garden. But how do you fire your hot tub correctly?

How is the water heated?

The bath water is heated with the wood stove and dry untreated firewood - you do not need electricity for this, because the thermodynamic circulation of water makes an electric pump unnecessary.

Correct lighting?

When firing, make sure that there is enough air supply. Then you can light the wood with a lighter or match. Wood shavings or cardboard, for example, have proven to be useful as a lighting aid.

What do I need to pay attention to when heating?

You should first check to see if there is any water left in the tub. Also, if you used your hot tub the night before, you should check the water level. To ensure that the water heats up quickly, use dry, high calorific value wood (Ideal: Beech, Oak, etc.). The pan must be filled with water to above the top of the stove before you start firing. This will prevent serious damage to your hot tub. Please remove all ash from the furnace.

How to reach the optimal bath temperature

Put on the thermal lid and start the stove. Once the fire is burning, load the stove completely with firewood. **To obtain the full stove output of 30 kW, the length of the logs must be 40 cm.** If necessary, keep adding logs to ensure continuous uniform combustion.

Once the water temperature reaches 32°C, load the burning stove fully with wood one last time. **An optimally loaded stove heats the pool by 10°C on average. This would give you an initial temperature of about 42°C.** By lifting the lid, approx. 2°C escape and by operating the spa system or stirring with the paddle, another 2-3°C. Now the water has the optimal bathing temperature of approx. 38°C.

How to maintain the heat while bathing

The residual heat of the stove keeps the water temperature constant for about 2-3 hours, depending on the outside temperature. After that, you can add 2-3 logs (40 cm) (please do not add more). This will increase the temperature by 2-3°C again. After that, add another log every half an hour. This way you keep the optimal bath temperature stable.

How quickly does the water warm?

Many specific factors play a big role in the heating time: How much water is in the hot tub? How big is the tub? What is the outside temperature? Calorific value of the wood and size of the logs? Do you use a cover? Based on our experience, we can say that 1,500 liters of water at an outside temperature of zero degrees Celsius will take 2-3 hours to reach a comfortable bathing temperature between 37-39 °C. With thermal cover and tub insulation you can reduce the heating time again by about 25%.

Please use the digital thermometer radio station for temperature measurement, which we give you with every hot tub.



Water cleaning

Filter pumps for water care

To enjoy your outdoor hot tub even longer, you need to protect the water from impurities. The most sustainable method of purifying water is to install a sand filter pump, which filters out the dirt and cleans the water. Thanks to the sand filter pump, you only need to change the water every 4-6 weeks. An additional integrated UV lamp also kills around 90 % of all germs and bacteria in the water.



Sand filters

With a sand filter you avoid frequent water changes and effectively filter the dirt out of your pool. Depending on the degree of contamination, in combination with an optional UV filter you can enjoy up to 3 months of clean water without having to replace it.

Power consumption: 400 Watts



UV Lamps

A sand filter cleans the water from fine dirt, while the UV filter removes 90% of all bacteria, germs and fungi. This means you need fewer chemical additives and is also gentle on your skin. Together with the right use of our water care products, an unbeatable combination for a carefree feel-good experience.



Maintaining the wood cladding

As the wood cladding constantly absorbs moisture from the outside, it needs suitable care. **The wood should be stained and oiled 2 - 3 times a year to prevent mould and cracks in the wood (linseed oil can be obtained in our shop).** Staining protects the wood against UV light and has a moisture-regulating effect. Oil provides an additional protective layer against weathering, has a dirt-repellent effect and the wood continues to show its natural appearance.

What is the condition of your water like? The analysis

In order to apply the correct pool care, an analysis of the water is first necessary. This is specifically about the acid-base balance / the pH value. This can change due to many influences, e.g. pool users, addition of chemicals or rain. Use a pH meter or a shake test (measuring strips are not recommended). The pool water should have a pH value between 7.0 and 7.4, because only in this range can water care products develop their full effect. If the value is significantly different, use pH-Plus (pH-value raiser) or pH-Minus (pH-value reducer) to change the value of the water accordingly. Due to the higher temperature in the hot tub (usually more than 28°C), chlorine is not the ideal permanent pool water care.



Application:

Holzklusiv Hot Tub Clean Care reliably prevents the growth of bacteria and fungi. Due to the high concentration of the product and the associated low application quantity, it is well tolerated by the bather and does not irritate the skin or the eyes.

Pre-treatment of the tub:

Before filling the pool, apply the undiluted product evenly in a thin layer on the walls and the floor. When re-dosing, the undiluted liquid is added to the water.

We recommend our Holzklusiv
Hot Tub Clean Care

Dosing quantity	Ø 180 cm	Ø 200cm	Opal
Before filling	90 - 180 ml	100 - 200 ml	50 - 100 ml
Re-dosing/week	35 - 65 ml	40 - 75 ml	20 - 40 ml



Technical data

Dimensioning

Ø 1,8 m

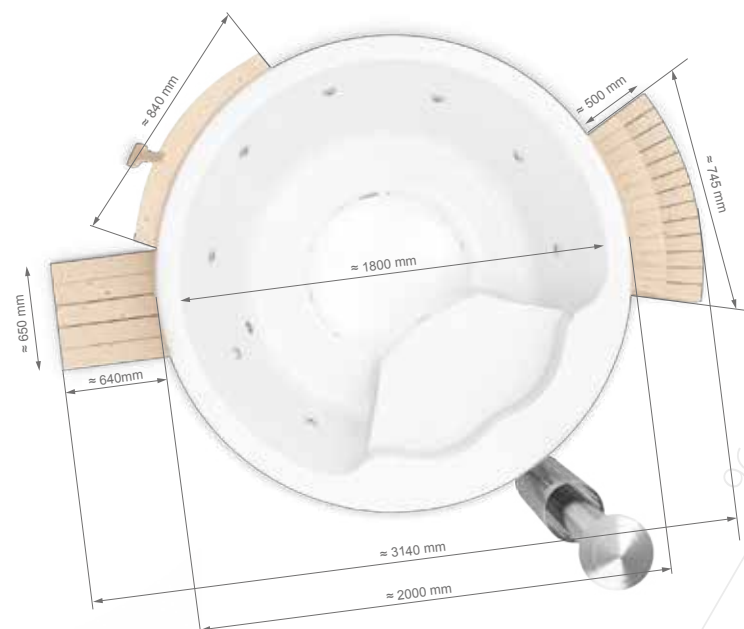
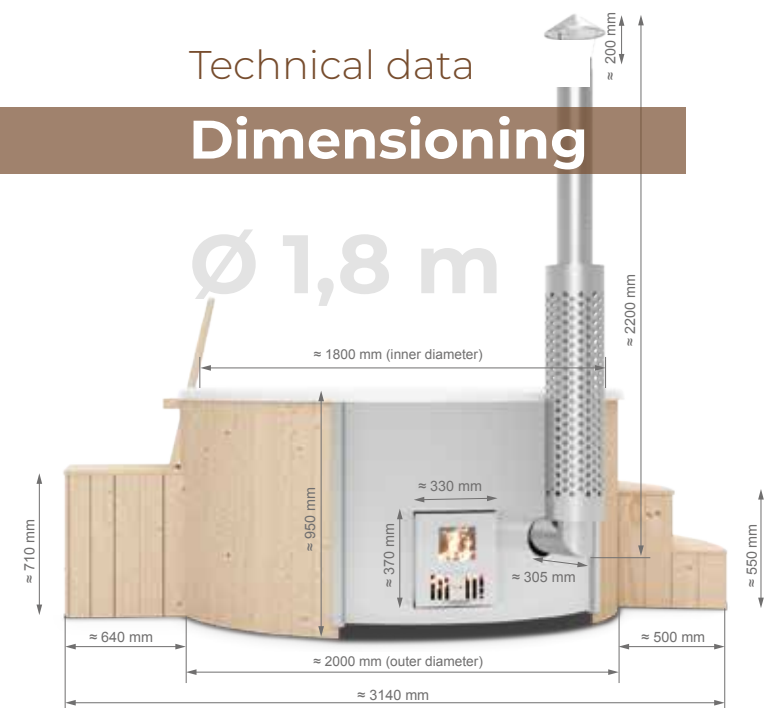

SAPHIR / JADE

GFK tub 180 cm

Inside diameter:	1800 mm
Outside diameter:	2000 mm
Inside height:	850 mm
Bench height:	300 mm
Bench depth:	450 mm
Water volume:	1300 l SAPHIR
	1800 l JADE
Weight (total):	200 kg

Ø 2 m

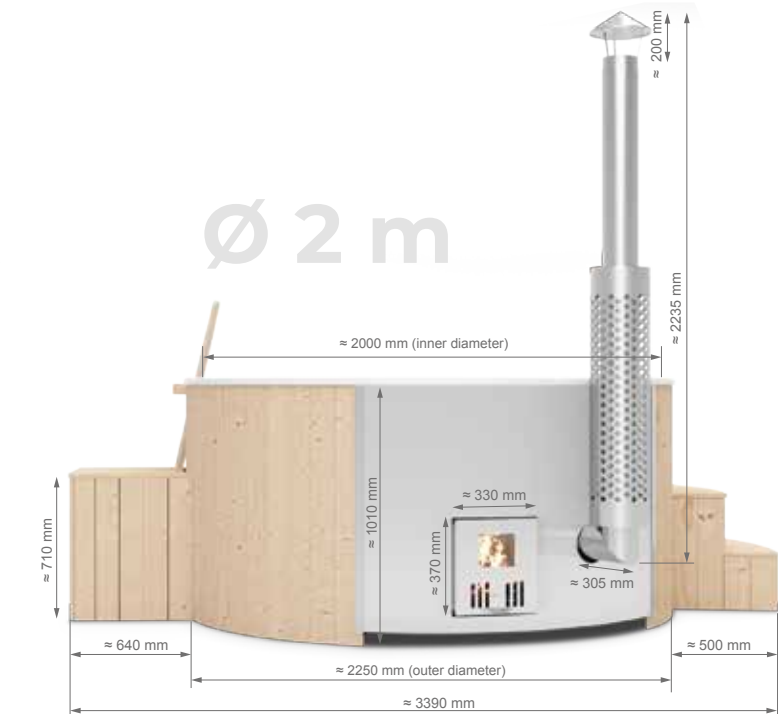

GFK tub 200 cm

Inside diameter:	2000 mm
Outside diameter:	2250 mm
Inside height:	900 mm
Bench height:	300 mm
Bench depth:	450 mm
Water volume:	1500 l SAPHIR
	2000 l JADE
Weight (total):	250 kg



Dimensioning

GFK tub 169 x 100 cm

Inner dimension (L/B): **1690 / 1000 mm**

Outer dimension: **1890 / 1185 mm**

Inside height: **900 mm**

Bench height: **300 mm**

Bench depth: **450 mm**

Water volume: **700 l**

Weight (total): **200 kg**

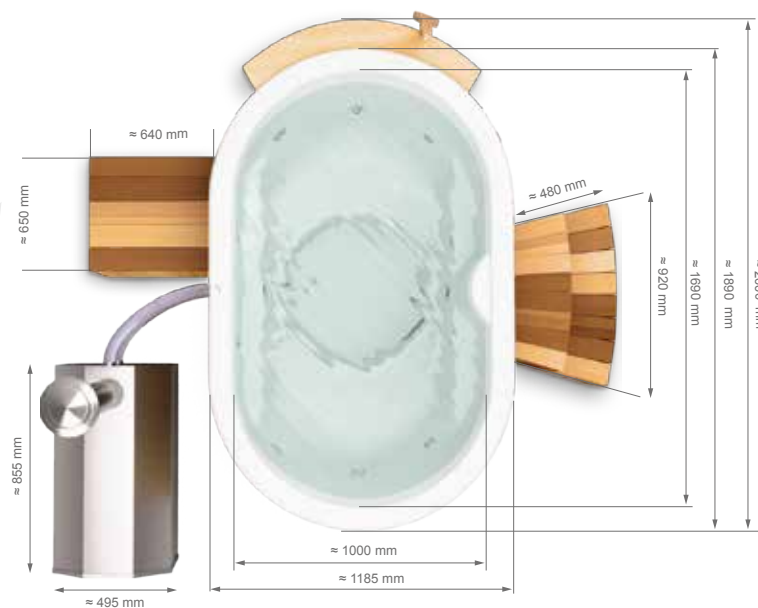
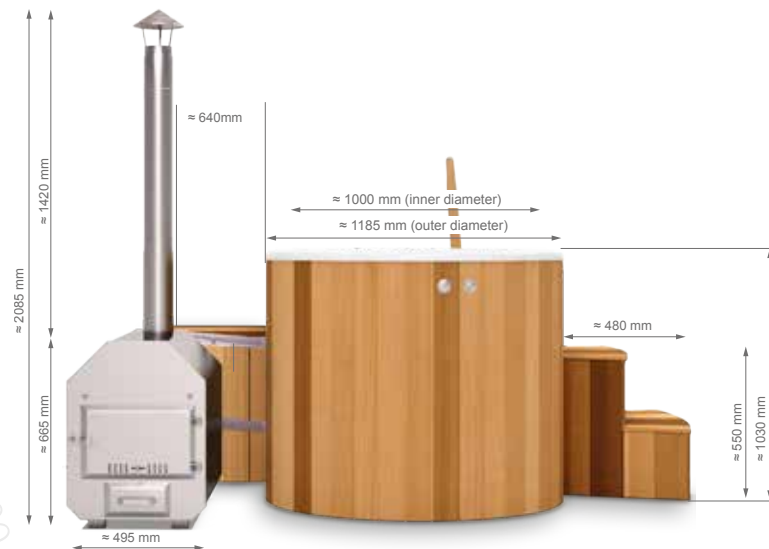

OPAL

Wellness for home



Construction



Abbildung 5: Explosionszeichnung
Hot Tub, Ausführungsvariante „SAPHIR“



A 220/240 volt Schuko power connection is needed to operate the entire wellness system (Lighting and SPA system).

Blower for the SPA air massage

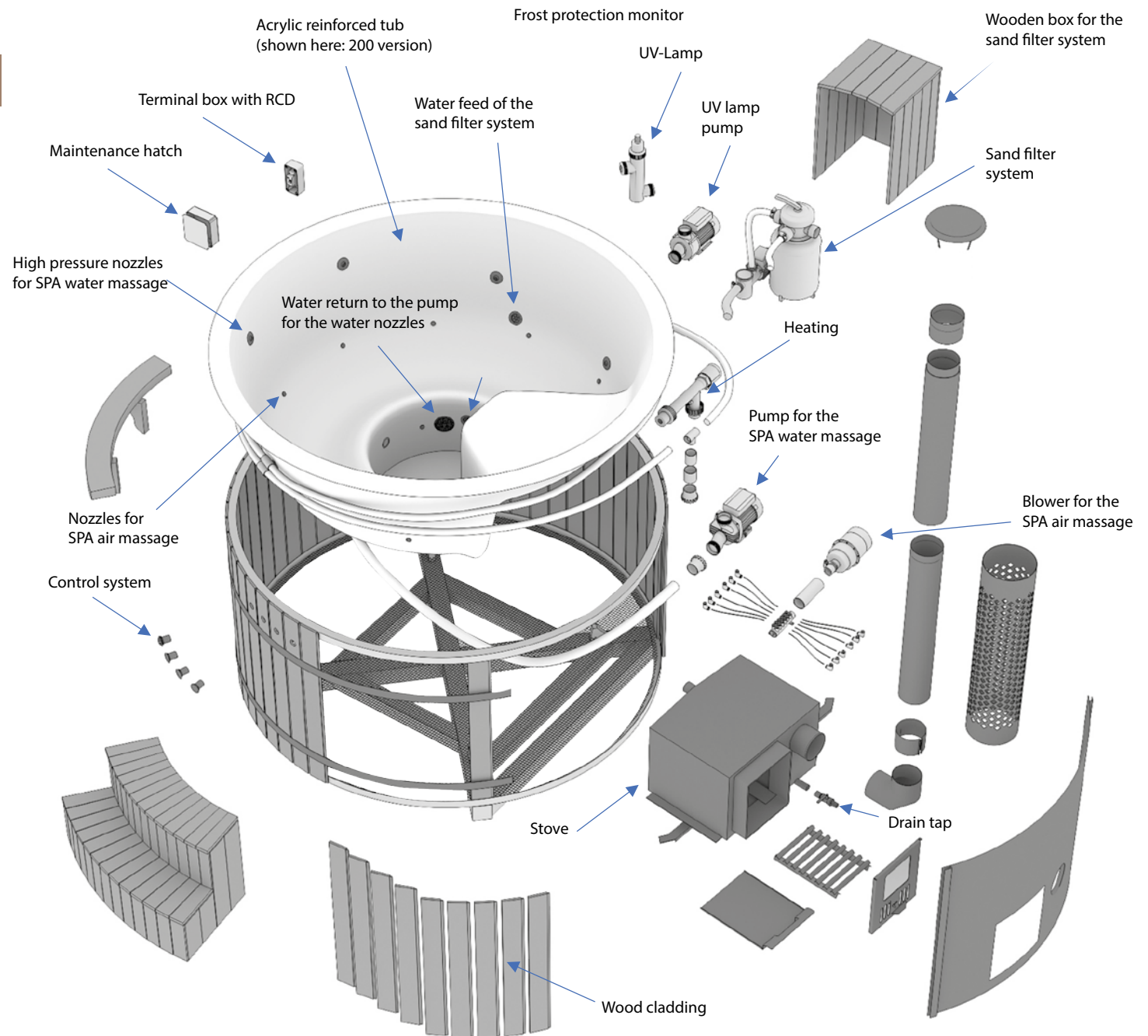

Volume: **max 2,5 m³/min**
 Max. operating pressure: **0025 Mpa**
 Power consumption: **800 Watt**
 Voltage: **230V 1N~ 50-60Hz**
 Current consumption: **3,6 A**
 Volume: **<73db(A)**
 Weight: **2,0kg**
 Permissible ambient temperature: **-10°C bis 50°C**
 Permissible air humidity: **max. 80%**

Pump for the SPA water massage



Volume: bis 440 Liter pro Minute
 Maximum pressure in meters: 12,8
 Power : **1,5 kW / 1.100 Watt**

Carefully selected materials for the parts that come into contact with water.
 Suction connection ø 50 mm
 adhesive connection.

Pressure connection
 Adhesive connection: T-component
 with 2 x ø 32 mm

Wood stove



Stainless steel stove 316

The heating elements and inserts of the 316 stainless steel stoves are resistant to chemicals (chlorine), salt or sea water.

Heating capacity: **30 kW**, material: **4VA**



Positioning switches and filters

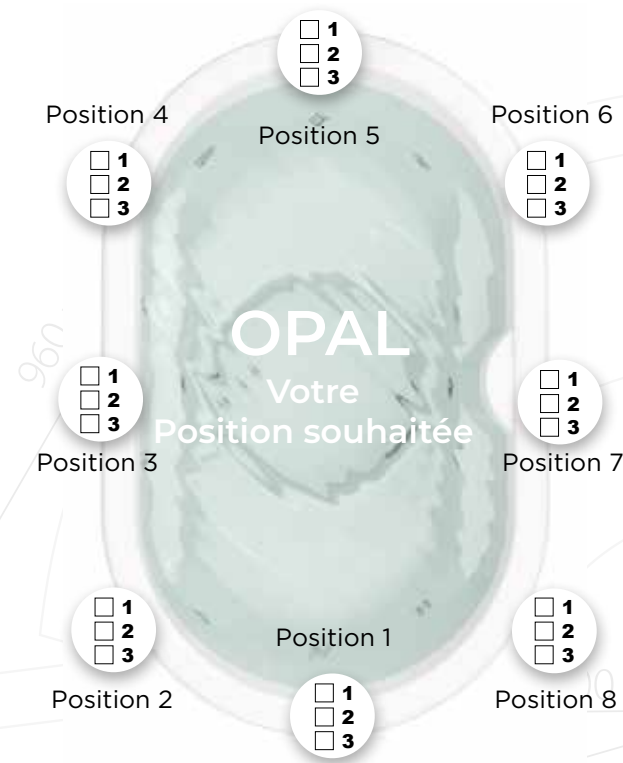
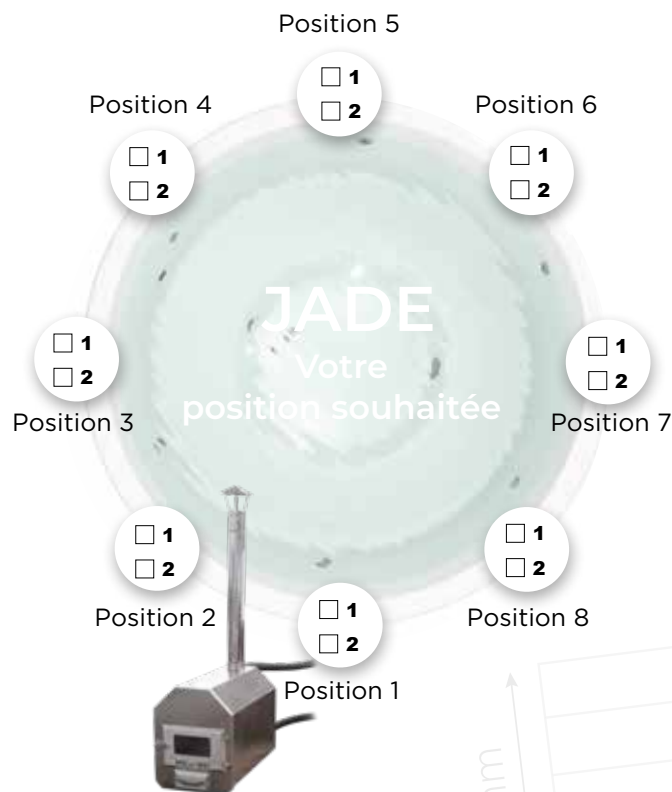
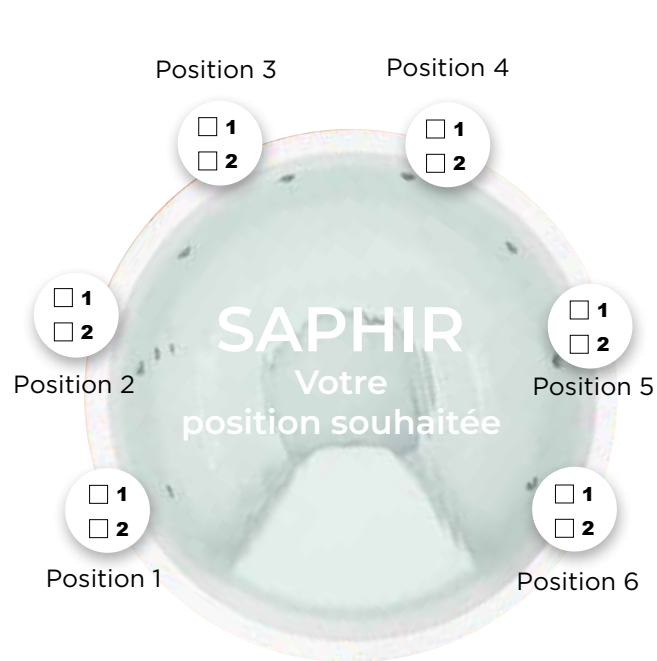

When ordering, you can determine the position of the variable elements of your hot tub yourself.

What do I need to consider?

The observance of your duty of care when setting up and operating a hot tub is considered paramount in order to avoid damage and injuries.

As a rule, fireplaces are subject to the limit values for CO₂ and dust emissions and minimum efficiency, laid down, in Germany, by the 2-stage BImSchV - the Federal Immission Control Ordinance. It contains, among other things, limit values for emissions in order to comply with or achieve the European directives on air pollution control.

By definition, private bathing stoves for solid fuels are exempt from the 1st BImSchV. In general, you can put a bath stove into operation as long as you have already observed other aspects such as house rules, ordinances of your State and / or municipality. Within the EU or the States, it is recommended to purchase a new bath stove that complies with the EU directives for air pollution control.

Since different regulations may apply in the various federal states, the final authority is always your chimney sweep, who decides whether the desired stove can also fulfil its tasks in terms of type, fire protection, delivery pressure, etc.



Showroom

EXPERIENCE HOLZKLUSIV





Visit our huge indoor and outdoor exhibition at our production site in Gummersbach.

Konfigurator

Plan comfortably from the sofa ...

With our configurator, specially developed for our hot tubs, you can plan your hot tub from the comfort of your own home and view the finished result in real time and from different perspectives.





Unique!
The virtual exhibition at www.holzklusiv.de

for home

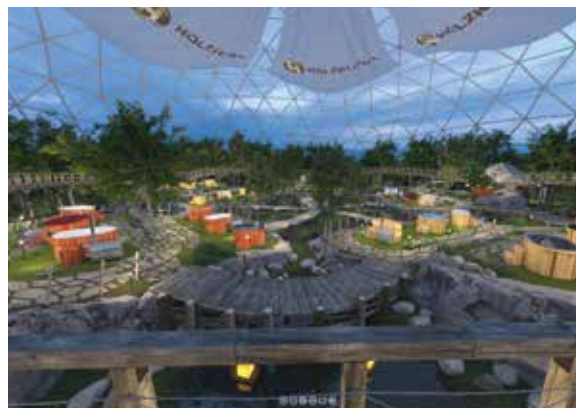

Wellness



*"Because we
love what we do"*

**That's why we build our hot tubs
ourselves**



Quality for a better quality of life

Made in Gummersbach

For us it is clear that best quality and customer-friendly service can only be guaranteed permanently with on-site production. On a production area of 1,350 sqm, our employees produce individually configured hot tubs made in Germany, by hand and with the most modern machines. We can proudly claim to be the only hot tub manufacturer in Germany.

We consistently focus on quality and do not use suppliers from Asia. Together with our exclusive partner from Austria we have completely redesigned our SPA systems for our hot tub. Both our pumps, blowers, jets, electronic components, the control system and the connection technology come 100% from the Koller factories in the EU. TÜV tested and CE certified – this is only available at HOLZKLUSIV.

At the same time we have applied the high quality standards standards of the manufacturer to the production of our Hot Tubs in Gummersbach. Regular training of our technical staff and continuous development work ensure consistent quality and safety standards.





HOLZKLUSIV GmbH

Stauweiher 5
51645 Gummersbach
Phone: 02261 9793065
Fax: 02261 9793048

E-Mail: info@holzklusiv.de
www.holzklusiv.de



HOLZKLUSIV
Wellness für Zuhause

